

PISTON PUMPS STRAIGHT AXLE ISO 3H: BI-ROTATIONAL

Part no.	Description	Working pressure (bar)	Displacement (cm³/rev)	Rotation frequency (rpm)	Suction port	Pressure port	Weight (kg)
14569100	PISTON PUMP 021L-BI-3H-AXIAL	350	20.25	1800	G1¼	G1	13.8
14569145	PISTON PUMP 028L-BI-3H-AXIAL	350	27.00	1800	G1¼	G1	13.8
14565535	PISTON PUMP 041L-BI-3H-AXIAL	350	40.50	1800	G1¼	G1	13.8

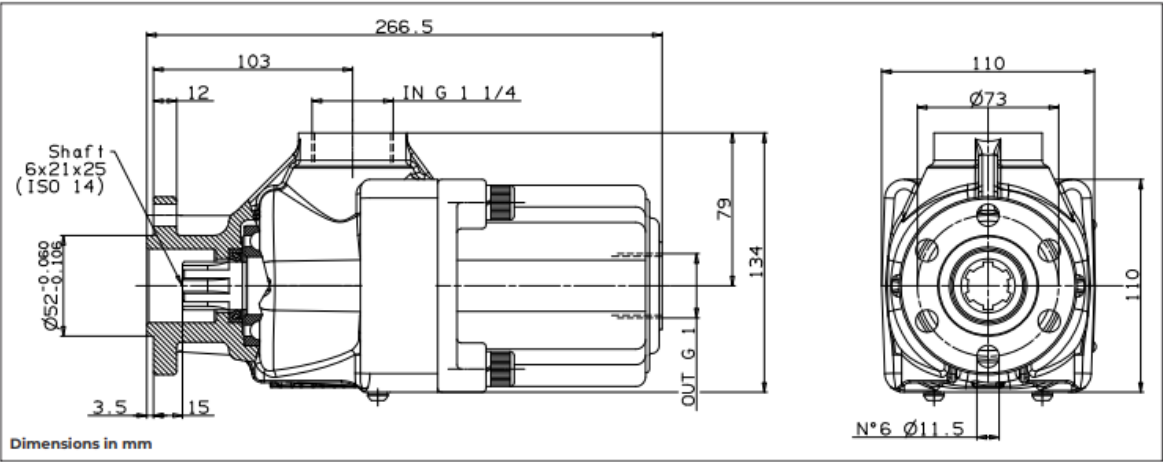

SEAL KITS

Part no.	Description
02410003	SEAL KIT FOR PISTON PUMP 21-60L STRAIGHT



PISTON PUMPS STRAIGHT AXLE ISO 4H: BI-ROTATIONAL

Part no.	Description	Working pressure (bar)	Displacement (cm ³ /rev)	Rotation frequency (rpm)	Suction port	Pressure port	Weight (kg)
14569140	PISTON PUMP 02IL-BI-4H-SA-1-1¼	350	20.25	1800	G1¼	G1	14.5
14569150	PISTON PUMP 028L-BI-4H-SA-1-1¼	350	27.00	1800	G1¼	G1	14.5

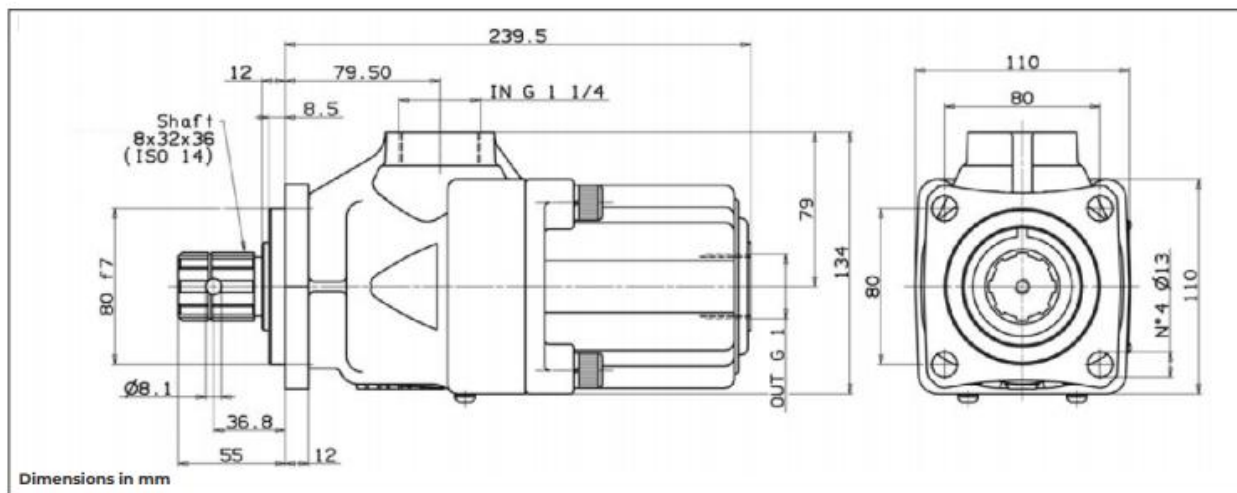

SEAL KITS

Part no.	Description
02410002	SEAL KIT FOR PISTON PUMP 21-60L STRAIGHT 4H

